

EXPAND BAND

SELF-EXPANDING SEALING TAPE

D
DIN 18542
BG 1

PERMANENT ELASTIC EXPANSION

The tape self-expansion remains elastic and unchanged over time, providing protection from water, dust and wind.

SAFETY

The modified polyurethane foam has passed the most stringent tests on harmful emissions, ensuring safe installation even indoors.

COMPOSITION

EXPAND BAND

elastic polyurethane foam with additives

release liner
silicone coated paper

EXPAND BAND EVO

elastic polyurethane foam with special film additives



CODES AND DIMENSIONS

EXPAND BAND

CODE	B			s			L			
	[mm]	[mm]	[mm]	[mm]	[mm]	[mm]	[in]	[mil]	[ft]	
EXPAND1014	10	1	4	13	0.4	39	157	43	48	
EXPAND1514	15	1	4	13	0.6	39	157	43	32	
EXPAND1549	15	4	9	8	0.6	157	354	26	32	
EXPAND15615	15	6	15	6	0.6	236	591	20	32	
EXPAND20920	20	9	20	4	0.8	354	787	13	24	
EXPAND40615	40	6	15	8	1.6	236	591	26	12	
EXPAND60615	60	6	15	8	2.4	236	591	26	8	

EXPAND BAND EVO

CODE	B			s			L			
	[mm]	[mm]	[mm]	[mm]	[mm]	[mm]	[in]	[mil]	[ft]	
EXPANDEVO1014	10	1	4	20	0.4	39	157	66	48	

TECHNICAL DATA

Properties	standard	value	USC conversion
Classification	DIN 18542	BG 1	-
Airtightness	EN 12114	$\alpha \leq 1,0 \text{ m}^3/(\text{h}\cdot\text{m}\cdot(\text{daPa})^n)$	-
Tightness in heavy rain	EN 1027	$\geq 750 \text{ Pa}$	-
Resistance to UV and weathering	DIN 18542	compliant with class BG 1	-
Compatibility with other building materials	DIN 18542	compliant with class BG 1	-
Water vapour transmission (Sd)	EN ISO 12572	$< 0,5 \text{ m}$	-
Reaction to fire	DIN 4102-1	class B1	-
Thermal conductivity (λ)	EN 12667	$\leq 0,043 \text{ W}/(\text{m}\cdot\text{K})$	$\leq 0,025 \text{ BTU}/\text{h}\cdot\text{ft}\cdot^\circ\text{F}$
Temperature resistance	-	$-30 / +90 \text{ }^\circ\text{C}$	$-22 / +194 \text{ }^\circ\text{F}$
Application temperature	-	$\geq +5 \text{ }^\circ\text{C}$	$\geq +41 \text{ }^\circ\text{F}$
Storage temperature ⁽¹⁾	-	$+1 / +20 \text{ }^\circ\text{C}$	$+33,8 / +68 \text{ }^\circ\text{F}$

⁽¹⁾Store the product in a dry, covered location for no more than 24 months.
Waste classification (2014/955/EU): 17 02 03.

FIELDS OF APPLICATION

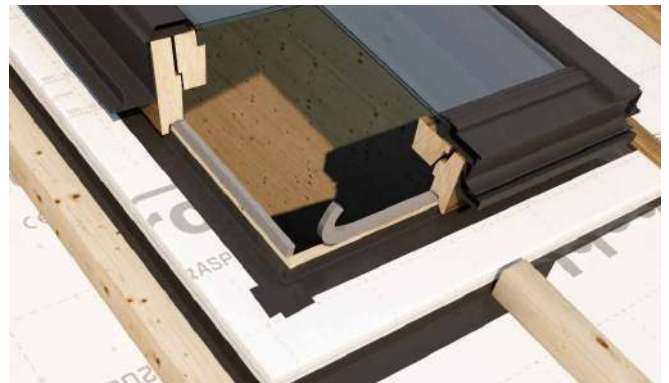

RELATED PRODUCTS



CUTTER
page 328



WINBAG
page 326



KOMPRI CLAMP
page 329



EVO VERSION

The EVO version not only reduces waste and installation time because it has no separating layer, but also has a special film that keeps its shape without self-expanding as long as it is rolled up.

SAFE PACKAGING

Supplied with a plastic core to prevent water and moisture absorption during construction, which could cause unwanted swelling.